

Standard product range

Standard-Lieferprogramm

Programme de livraison standard

Programa de suministro estándar

Programma di produzione standard

11/2008

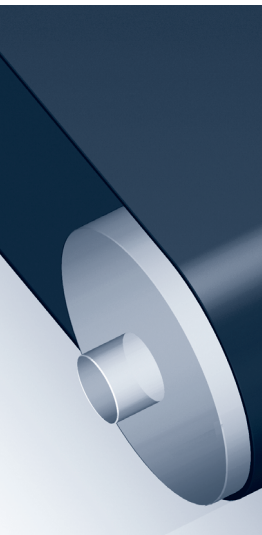

siegling transilon

conveyor and processing belts

transport- und prozessbänder

bandes de transport et de process

bandas de transporte y procesamiento

nastri trasportatori e per processi di lavorazione



MOVEMENT SYSTEMS

Type code | Typenschlüssel | Signification des symboles | Clave de tipos | Denominazione tipi

| | | | | | | | | | |
|-------------------------|-----------------|----------|---|-------------------------------------|----------|-----------------------------------|---|------------|----------------------------|
| E | 10 | / | M | V1 | / | V10 | green | | |
| E | 8 | / | 2 | U0 | / | V5 | white | FDA | |
| Material of fabric | Type class | | Number of plies or special fabric (M or H) | Underside coating* | | Top face coating* | Surface finish/ Belt property | Colour | Belt property |
| Werkstoff des Gewebes | Typklasse | | Lagenzahl oder Spezialgewebe (M oder H) | Laufseitenbeschichtung* | | Tragseitenbeschichtung* | Oberflächen-ausführung/ Bandeigenschaft | Farbe | Band-eigenschaft |
| Matière du tissu | Classification | | Nombre de plis ou tissu spécial (M ou H) | Revêtement de la face de roulement* | | Revêtement de la face porteuse* | Type de surface/ propriété de la bande | Couleur | Propriété de la bande |
| Material del tejido | Categoría | | Cantidad de capas o tejido especial (M o H) | Recubrimiento cara de circulación* | | Recubrimiento cara de transporte* | Tipo de superficie/propiedad de la banda | Color | Propiedad de la banda |
| Composizione della tela | Classificazione | | Numero tele o tela speciale (M o H) | Copertura superficie scorrimento* | | Copertura superficie trasporto* | Esecuzione della superficie superiore/ caratteristiche del nastro | Colore | Caratteristiche del nastro |

* This figure represents the thickness of the belt's coating in 1/10 mm; e.g. V5 represents 0.5 mm of PVC coating. | Zahlenangabe bedeutet Beschichtungsdicke in 1/10 mm, z.B. V5 = 0,5 mm PVC. | Le chiffre indique l'épaisseur du revêtement en 1/10 mm, p.ex. V5 = 0,5 mm PVC | La cifra indica el espesor del recubrimiento en 1/10 mm, p.ej., V5 = 0,5 mm de PVC. | La parte numerica determina lo spessore della copertura in decimi di mm, es: V5 = 0,5 mm di PV

Abbreviations | Abkürzungen | Abréviations | Abreviaturas | Abbreviazioni

| | | | | | |
|-----------|-----------------------------------|--------------------------------|---------------------------------|---------------------------------|-----------------------------|
| | Tension member | Zugträgerausführungen | Couches de traction | Elementos tractores | Nucleo di trazione |
| AE | Aramide/polyester blended fabric | Aramid/Polyester-Mischgewebe | Combinaison Aramide/Polyester | Mezcla de aramida y poliéster | Aramide/misto poliestere |
| E | Polyester | Polyester | Polyester | Poliéster | Poliestere |
| EC | Polyester/cotton blended fabric | Polyester/Baumw.-Mischgewebe | Combinaison Polyester/Coton | Mezcla de poliéster y algodón | Poliestere misto lana |
| EP | Polyester/polyamid blended fabric | Polyester/Polyamid-Mischgewebe | Combinaison Polyester/Polyamide | Mezcla de poliéster y poliamida | Poliestere misto poliammide |
| P | Polyamide | Polyamid | Polyamide | Poliammida | Poliammide |

| | | | | | |
|----------------|------------------------|------------------------|---------------------|---------------------------|-----------------------------|
| | Design | Konstruktion | Construction | Construcción | Costruzione |
| 1, 2, 3 | Number of fabric plies | Anzahl der Gewebelagen | Nombre de plis | Número capas textiles | Transilon a 1, 2 o tre tele |
| M | Solid-woven material | Mehrlagengewebe | Multi-plis | Tejido capas múltiples | Tela multistrato |
| NOVO | Polyester non-woven | Polyesterfaservlies | Fibres polyester | Fibras de poliéster | Fibra di poliestere |
| H | HighTech-fabric | HighTech-Gewebe | Tissu HighTech | Tejido de alta tecnología | Tela HighTech |

| | | | | | |
|---------------------------|------------------|-----------------------|--------------------|-----------------------|---------------------|
| | Coatings | Beschichtungen | Revêtements | Recubrimientos | Coperture in |
| A | Polyolefin | Polyolefin | Polyoléfina | Polioléfina | Polioléfina |
| C | Cotton | Baumwolle | Coton | Algodón | Cotone |
| E | Polyester | Polyester | Polyester | Poliéster | Poliestere |
| G | Rubber/elastomer | Gummi/Elastomer | Gomme | Goma | Elastomero |
| P | Polyamide | Polyamid | Polyamide | Poliammida | Poliammide |
| S | Silicone | Silikon | Silicone | Silicona | Silicone |
| U | Urethane | Urethan | Uréthane | Uretano | Uretano |
| UH | Hard urethane | Urethan hart | Uréthane dur | Uretano duro | Uretano duro |
| V | PVC | PVC | PVC | PVC | PVC |
| VH | Hard PVC | PVC hart | PVC dur | PVC duro | PVC duro |
| VS | Soft PVC | PVC weich | PVC mou | PVC suave | PVC morbido |
| O | Uncoated | Unbeschichtet | Sans revêtement | Sin recubrimiento | Senza copertura |
| F, Z | Felt/velour | Filz/Velour | Feutre/velours | Fieltro/velour | Coperture speciali |
| U0, E0, A0, S0, Y0 | Impregnated | Mit Imprägnierung | Avec imprégnation | Con impregnación | Impregnato |

| | | | | | |
|--------------|----------------------------|-----------------------------|---------------------------------------|---------------------------------------|--|
| | Top face patterns | Tragseitenstrukturen | Structures des faces porteuses | Estructuras cara transporte | Tipi di superfici di trasporto |
| AR | Anti-skid pattern | Anti-Rutsch-Struktur | Structure antidérapante | Antirresbalante | Struttura antiscivolo |
| CH | Check-in pattern | Check-In-Struktur | Structure de check-in | Facturación en mostrador | Struttura quadrata |
| FG | Herringbone pattern | Fischgrät-Struktur | Structure en arêtes de poisson | Espina de pez | Struttura a "spina di pesce" |
| FSTR | Fine textured pattern | Feinstruktur | Structure fine | Fina | Struttura fine |
| GL | Smooth surface | Glatte Oberfläche | Surface lisse | Superficie lisa | Superficie liscia |
| GSTR | Coarse textured pattern | Grobstruktur | Grosse structure | Gruesa | Struttura grossa |
| KN | Cross-stud pattern | Kreuznoppenstruktur | Structure à nopes en croix | Nudos cruciformes | Struttura „croce“ |
| LG | Longitudinal groove | Längsrille | Rainures longitudinales | Ranura longitudinal | Rigature longitudinali |
| MT | Matt surface | Matte Oberfläche | Surface mate | Superficie mate | Superficie opaca |
| NP | Inverted pyramid pattern | Negative Pyramidenstruktur | Structure en pyramide inversée | Piramidale negativa | Struttura a piramide inversa |
| R | Large diamond pattern | Rautenstruktur | Structure rhombique | Rómbica | Struttura romboidale |
| RF | Fine rhomboid pattern | Rhombenfeinstruktur | Structure rhombique fine | Rómbica fina | Struttura fine romboidale |
| RFF | Flat fine rhomboid pattern | Rhombenfeinstruktur, flach | Structure rhombique fine et plate | Rómbica fina plana | Struttura fine romboidale, piana |
| RPH | High round profile pattern | Rundprofilstruktur, hoch | Structure de profil en arrondi, haute | Estructura de perfil redondo, elevada | Struttura semisferica longitudinale alta |
| R80 | Rhomboid pattern | Rhombenstruktur | Structure rhombique | Estructura rómbica | Romboidale |
| SG | Lattice pattern | Gitterstruktur | Structure de grille | Reticular | Struttura reticolato |
| SP | Star pyramid pattern | Sternpyramidenstruktur | Structure pyramidale en étoile | Estructura de pirámide estrella | Struttura a piramide con base a stella |
| STR | Normal textured pattern | Normalstruktur | Structure normale | Normal | Struttura normale |
| VN | Staggered stud pattern | Vertikale Noppenstruktur | Structure nopes en V | Nudos en V | Struttura losanghe |
| WAR | Wavy anti-skid pattern | Wellen-Anti-Rutsch-Struktur | Structure antidérapante en vagues | Estructura antirresbalante de ondas | Struttura a nido d'ape ondulata |
| Rough | Rough pattern | Grobe Gewebestruktur | Structure tissu | Tejido estructurado grueso | Ruvido |
| Fine | Fine pattern | Feine Gewebestruktur | Structure fine tissu | Tejido estructurado fino | Sottile |

| | | | | | |
|--------------|---|---|---|---|--|
| | Belt properties | Bandeigenschaften | Caractéristiques de la bande | Propiedades de la banda | Caratteristiche del nastro |
| ATEX | Explosion protection with specific compliance to guidelines | Ex-Schutz mit spezifischer Richtlinienkonformität | Répond aux normes européennes concernant les équipements utilisés en atmosphère explosive | Protección contra explosiones con conformidad ATEX | Conforme alle normative ATEX |
| C | Laterally flexible, suitable for curved belts | Querweich, kurvenbandtauglich | Souple transversalement, adapté pour bandes courbes | Flexibilidad transversal, apto para bandas curvas | Trasversalmente flessibile, idoneo per curve |
| FDA | FDA-compliant | FDA-konform | Répond aux normes de la FDA | Homologado por la FDA | Conforme alle normative FDA |
| HACCP | Supports the HACCP concept | Unterstützung des HACCP-Konzeptes | Support du concept HACCP | Cumple con el protocolo HACCP | Supporto del concetto HACCP |
| HC | Highly-conductive | Hochleitfähig | Hautement conductible | Alta conductividad | Altamente conduttivo |
| HW | Hot water | Heißwasserbeständig | Eau chaude | Agua caliente | Acqua bollente |
| LF | Low friction | Besonders reibungsarm | Faible coefficient de frottement | Bajo rozamiento | Basso coefficiente di attrito |
| M | Particularly stiff laterally | Besonders quersteif | Particulièrement rigide transversalement | Rigidez transversal especial | Particolarmente rigido trasversalmente |
| NA | Non-antistatic | Nicht antistatisch | Non antistatique | Non antistático | Non antistatico |
| S | Very low noise | Geräuscharm | Silencieux | Insonorizado | Funzionamento silenzioso |
| SE | Flame-retardant | Schwel entflammbar | Difficilement inflammable | Difficilmente inflamable | Difficilmente infiammabile |
| TT | Pyrolysis compliant | Pyrolyse-konform | Conforme à pyrolyse | Cumple con la norma de la pirólisis | Conforme alle norme sulla pirólisi |
| Q | Laterally soft tension member, not for curved belts | Querweicher Träger, nicht für Kurvenband | Couche de traction souple transversalement, non adapté pour bandes courbes | Sin rigidez transversal, no apto para bandas curvas | Nucleo di trazione trasversalmente flessibile, non idoneo per trasporto in curva |

Siegling – total belting solutions

All the current data on our Siegling Transilon product range and technical information on the products can be found on the internet under www.forbo-siegling.com

Die jeweils aktuellen Daten unseres Siegling Transilon Lieferprogrammes und technische Hinweise zu den Produkten finden Sie im Internet unter www.forbo-siegling.com

Toutes les informations sur notre programme de livraison Siegling Transilon et les informations techniques se trouvent sur l'internet sous www.forbo-siegling.com

Toda la información actualizada sobre el programa de suministro de Siegling Transilon y las hojas de datos técnicos de nuestros productos pueden encontrarse en Internet www.forbo-siegling.com

L'aggiornamento in tempo reale del programma di produzione standard Siegling Transilon e le informazioni tecniche sui nostri prodotti sono disponibili in Internet www.forbo-siegling.com

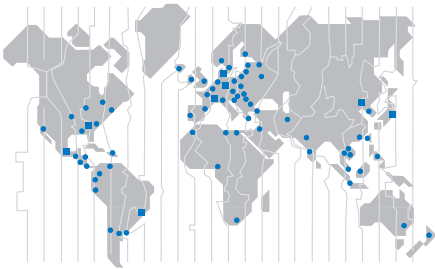

Forbo Siegling Service – anytime, anywhere

In the company group, Forbo Siegling employs more than 2000 people worldwide.

Our production facilities are located in eight countries; you can find companies and agencies with stock and workshops in more than 50 countries.

Forbo Siegling service centres provide qualified assistance at more than 300 locations throughout the world.



MOVEMENT SYSTEMS

Forbo Siegling GmbH
Lilienthalstrasse 6/8, D-30179 Hannover
Phone +49 511 6704 0, Fax +49 511 6704 305
www.forbo-siegling.com, siegling@forbo.com

**Forbo Movement Systems is part of the Forbo Group,
a global leader in flooring, bonding and movement systems.**